

That's an error.

That's all we know.

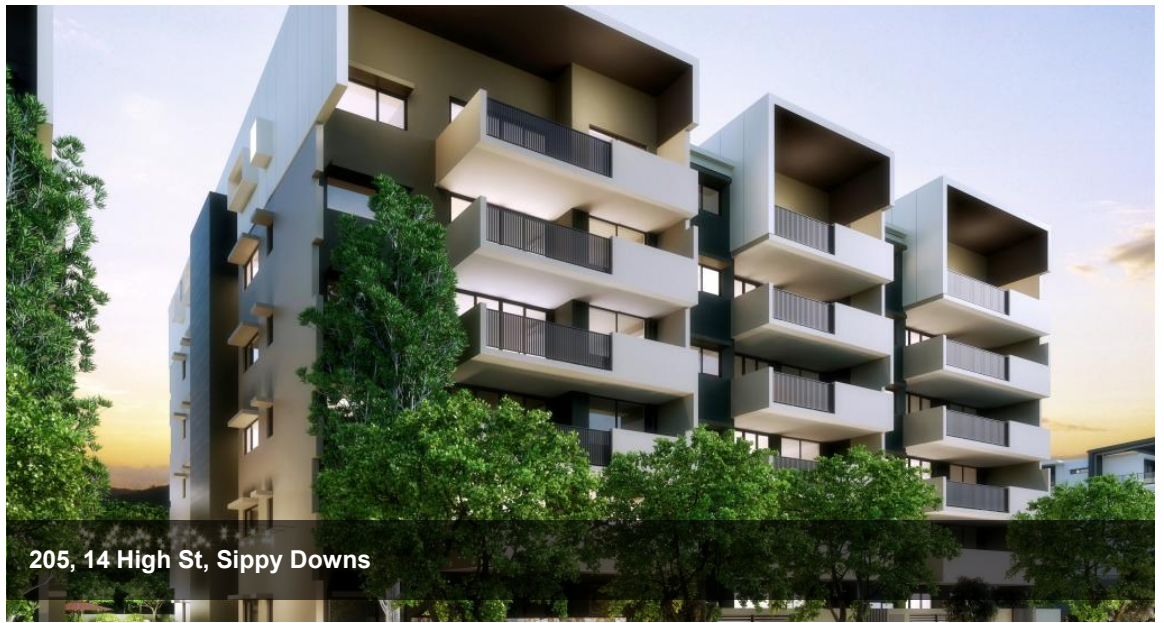

205, 14 High St, Sippy Downs



2 AND 3 BEDROOM APARTMENTS UNDER \$399,000 RELAXED URBAN LIVING.

Forest Edge apartments are architecturally designed to maximise lifestyle and functionality.

A private balcony to each apartment makes it easy to soak up the tranquil surrounds with Northerly views to the hinterland.

The spacious and contemporary open-plan interiors are complemented by premium finishes throughout, including:

- Stainless steel appliances
- Walk-in pantry
- Split system air-conditioning
- Stone bench tops
- Floor-to-ceiling windows to the living room.

Residents of Forest Edge will be the envy of the Sippy Downs neighbourhood.

Outside the beautiful designs continue with a Landscaped Podium Deck overlooking the 25 Metre Resort Pool and comprising Outdoor Dining & Living Rooms. Complimented with Barbeque Areas around the Gardens.

Situated in the heart of thriving Sippy Downs, Forest Edge holds tremendous appeal for residents and investors alike. Sippy Downs is a burgeoning technology hub with close proximity to schools, University of the Sunshine Coast, public transport facilities, shopping attractions and employment opportunities.

With only a limited number of apartments still available, now is the time to start planning your next investment or future home.

Call us today for a private inspection and more information:

Beatrice Borns 0402 972 763

Simon Bruce 0448 00 00 88

2 2

Price 2 Bedroom Apartments
Under \$399,000

Property Type Residential

Property ID 3783

AGENT DETAILS

Beatrice Borns - 0402 972 763

Justin Voss - 0400 822 069

OFFICE DETAILS

Mooloolaba

Unit 1 24 Brisbane Rd Mooloolaba,

QLD, 4557 Australia

0754456500



The above information provided has been furnished to us by the vendor/s. We have not verified whether or not that information is accurate and do not have any belief in one way or the other in its accuracy. We do not accept any responsibility to any person for its accuracy and do no more than pass it on. All interested parties should make and rely upon their own inquiries in order to determine whether or not this information is in fact accurate.